

INSTALLATION PROCEDURE

1 LOCATE WELDNUT ANCHOR HOLE BY FEELING THROUGH THE SOFT HEADLINING, DIE PUNCH A .80 DIA. HOLE IN THE SOFT HEADLINING AND INSTALL TIP HALF OF SHOULDER BELT AS SHOWN IN VIEW IN CIRCLE Z USING C/OUTS A AND D. CLOSE ANCHOR COVER.

2 LOCATE SCREW HOLES BY FEELING THROUGH THE SOFT HEADLINING AND INSTALL C/OUT B AS SHOWN IN VIEW IN CIRCLES X & Y USING C/OUT E SLIP C/OUT C OVER C/OUT B

3 THE DIMPLE IN THE CLIP MUST ENGAGE THE HOLE IN THE TIP FOR PROPER STOWAGE.

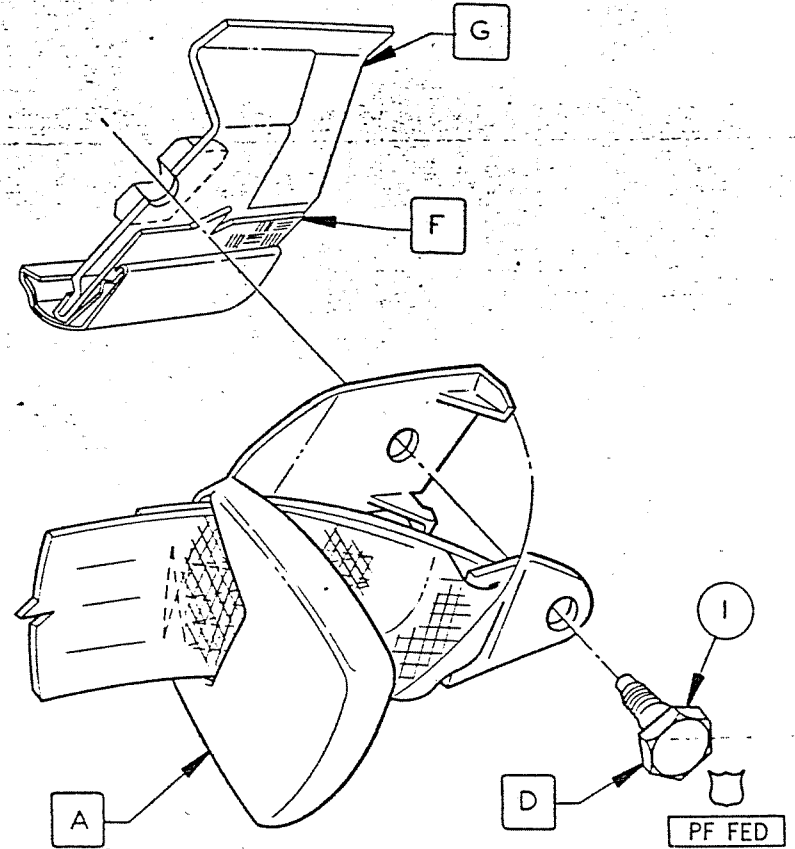
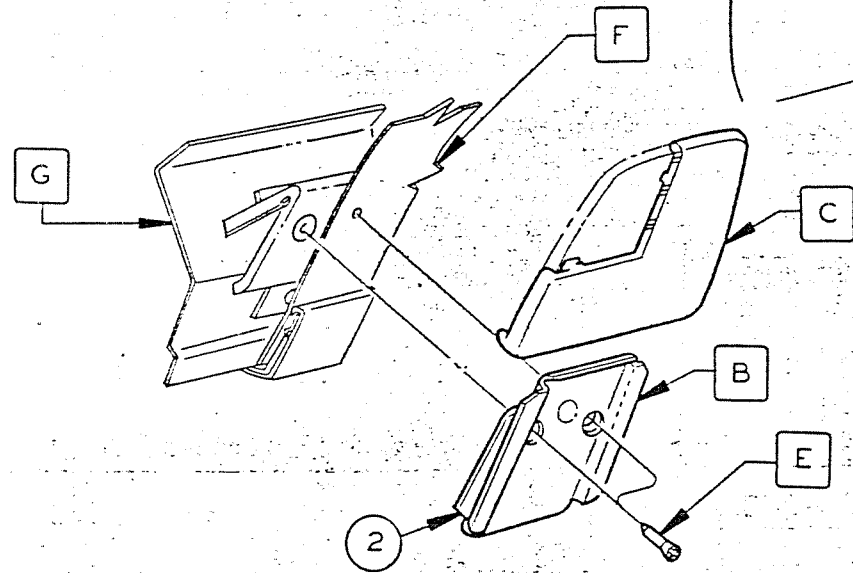
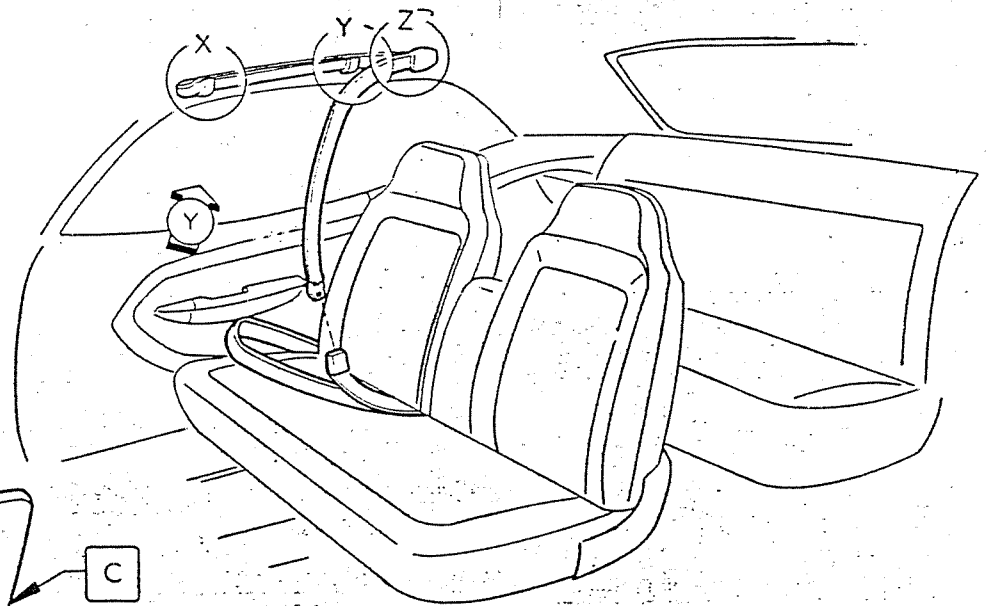

- A 2999588 (S/O 2999566) BELT ASSY-FRT SEAT SHOULDER BUCKLE HALF (2 REQ'D)
- B 2999865 CLIP-SHOULDER BELT STOWAGE (4 REQ'D)
- C 2999864 COVER-STWG FRT SEAT SHLDR BELT (4 REQ'D)
- D 6027311 (S/O 6027310) SHOULDER BOLT
- E 6028962 SCREW
- F HEADLINING ASSY
- G ROOF RAIL ASSY

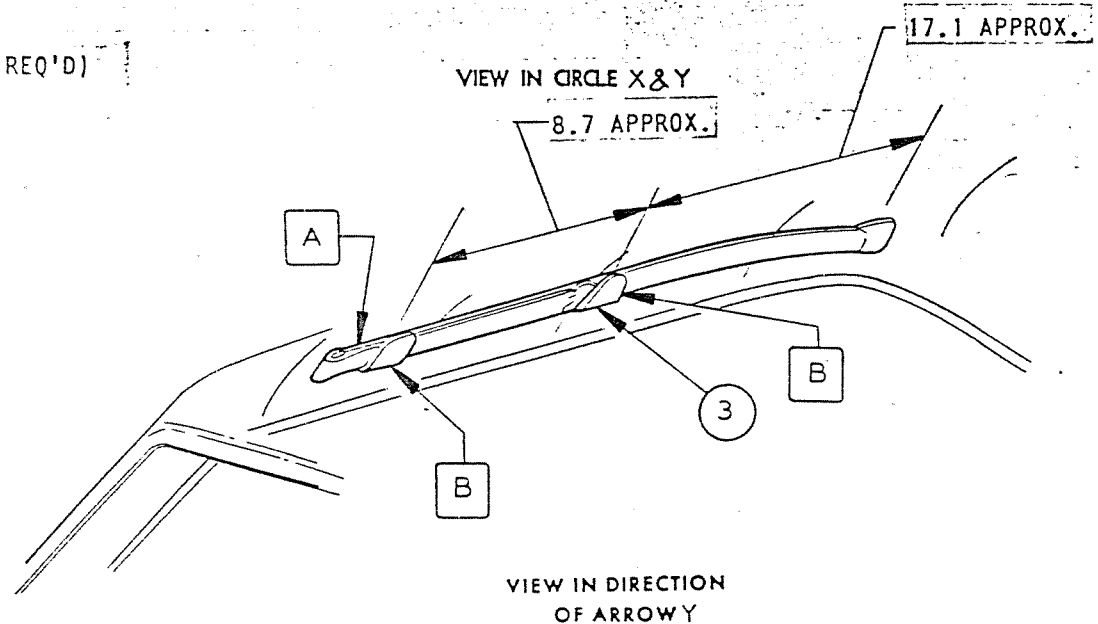

208 & 210

INSTRUCTIONS

		MODELS FG/BJ-0-00 (EXC MOD 27)	
		DRAWN DVF/DR CHECKED S. BLACK APP. EP APP. J... DATE 3-17-69	MANUAL NO. 2654911 SECT. ON 1 PAGE E 3.0
		ENGINEERING ILLUSTRATION DEPT. 3440	PRODUCT PLANNING & DEVELOPMENT STAFF CHRYSLER CORPORATION
		FRONT SEAT SHOULDER BELT	
		G SER MODS ADDED 90627-956 C/OUT E WAS 94255-1 1/26 8 75/87	

